



| Product No. | Description | U.P.C. Code | Cu.Ft. | Ctn. Qty. | Ctn. Wt. |
|---|---|--------------|--------|-----------|----------|
| DOMESTIC SINK STRAINERS (MADE IN U.S.A.) | | | | | |
| L7 | "Lucky 7" Sink Basket Strainer, Chrome Plated Brass Body w/ Stainless Steel Basket, Metal Post, Heavy Locknut, Rubber Stopper, Extra Thick Washer, Machine Cut Threads. | 041193071002 | 1.0 | 24 | 24 |
| L7BN | Same as L7 w/ Brass Nuts | 041193103635 | 1.0 | 24 | 28 |
| L7T | Same as L7 w/ 4" Chrome Plated Tailpiece | 041193071019 | 1.0 | 24 | 27 |
| 4201-L7-3 | Replacement Basket for L7 | 041193114709 | .01 | 1 | .25 |



| | | | | | |
|-----------|--|--------------|-----|----|-----|
| L74 | "Lucky 7" Sink Basket Strainer, w/ Stainless Steel 4-Prong Basket, Chrome Plated Brass Body, Metal Post, Rubber Stopper, Heavy Locknut, Extra Thick Washer, Machine Cut Threads. | 041193016034 | 1.0 | 24 | 24 |
| L74T | Same as L74 w/ 4" Tailpiece. | 041193016041 | 1.0 | 24 | 28 |
| 4204-L7-3 | Replacement Basket for L74 (4-Prongs) | 041193028242 | .01 | 1 | .25 |



| | | | | | |
|--------|---|--------------|-----|----|----|
| DB1000 | Locking Cup Sink Basket Strainer, Stainless Steel Body and Basket, Galvanized Steel Locking Cup, Plastic Post and Rubber Stopper. | 041193014993 | 1.0 | 24 | 20 |
|--------|---|--------------|-----|----|----|



| | | | | | |
|------------|---|--------------|-----|----|-----|
| DB1000EZBN | EZ-Mount Sink Basket Strainer with Stainless Steel Body and Basket with EZ-Mount Connection and Brass Nut, Plastic Post and Rubber Stopper. | 041193014948 | 1.0 | 24 | 25 |
| 4204-00-3 | Replacement Basket for DB1000 | 041193022349 | .01 | 1 | .25 |



| | | | | | |
|-----------|--|--------------|-----|----|-----|
| DB1120 | Deep Locking Cup Sink Basket Strainer, Stainless Steel Body and Basket, Rubber Stopper w/ Snap-In Basket. Length - 3-3/4". | 041193011534 | 1.3 | 24 | 30 |
| DB1120BN | Same as DB1120 w/ Brass Nuts. | 041193014849 | 1.3 | 24 | 30 |
| 4204-20-3 | Replacement Basket for DB1120 | 041193022332 | .01 | 1 | .25 |



| | | | | | |
|---------|--|--------------|-----|----|----|
| DB711 | "Spin-N-Lock" Sink Basket Strainer, Chrome Plated Brass Body w/ Stainless Steel Screw-In Basket, Brass Turning Nut | 041193011541 | 1.0 | 24 | 30 |
| DB711BN | Same as DB711 w/ Brass Nuts | 041193014832 | 1.0 | 24 | 35 |



| | | | | | |
|-----------|---|--------------|------|----|-----|
| DB711EZ | "Spin-N-Lock" Sink Basket Strainer, Chrome Plated Brass Body w/ Stainless Steel Screw-In Basket and EZ-Mount Connection | 041193014962 | 1.06 | 24 | 35 |
| 4204-11-3 | Replacement Basket for DB711 | 041193022363 | .01 | 1 | .25 |



| | | | | | |
|-------------------------------|--|--------------|-----|----|----|
| ECONOMY - NON-DOMESTIC | | | | | |
| 12 | Medium Cup Basket Strainer, Stainless Steel Body and Basket, Medium Locking Cup, Neoprene Stopper, Bright Flange, Length 3-1/8" Fits Deep Cast Iron Sinks. | 041193093653 | 1.2 | 24 | 16 |

| Product No. | Description | U.P.C. Code | Cu.Ft. | Ctn. Qty. | Ctn. Wt. |
|-------------------------------------|---|--------------|--------|-----------|----------|
| LOCKING CUP STRAINERS (CONT) | | | | | |
| 14 | Shallow Cup Basket Strainer, Stainless Steel Body and Basket Shallow Locking Cup. Neoprene Stopper w/ Snap-In Basket w/ Bright. Flange. Length- 2-3/4". Fits Deep Cast Iron Sinks | 041193006110 | .98 | 24 | 14 |
| 14T | Same as 14 w/ 4" Chrome Plated Tailpiece | 041193102140 | .70 | 24 | 18 |
| 4204-14-3 | Replacement Basket for 14 (new style with metal snap-in spring) | 041193028228 | .01 | 1 | .17 |



| | | | | | |
|-----------|---|--------------|-----|----|-----|
| 15 | "Snap-N-Tite" Sink Basket Strainer, Stainless Steel Body and Basket. Locking Cup. Neoprene Stopper. Fits cast iron sinks. Length 3-3/4" | 041193110091 | 1.4 | 24 | 22 |
| 15T | Same as 15 w/ 4" Chrome Plated Tailpiece (Fits all cast iron) | 041193085733 | 1.4 | 24 | 22 |
| 15BN | Same as 15 w/ Brass Nuts. Neoprene Stopper with Brass Nuts. (Fits all cast iron) | 041193011572 | 1.4 | 24 | 22 |
| 4201-15-3 | Replacement Basket for 15 | 041193114723 | .01 | 1 | .20 |



| | | | | | |
|-----------|--|--------------|-----|----|-----|
| 18 | Sink Basket Strainer, Stainless Steel Body and Basket. Deep Locking Cup. Neoprene Stopper. Length-3-3/4" | 041193110329 | 1.4 | 24 | 18 |
| 18T | Same as 18 w/ 4" Chrome Plated Tailpiece | 041193056023 | 1.4 | 24 | 22 |
| 18BN | Same as 18 w/ Brass Nuts | 041193011596 | 1.4 | 24 | 20 |
| 4204-18-3 | Replacement Basket for 18 (new style with metal snap-in spring) | 041193028235 | .01 | 1 | .17 |



EASY MOUNT STRAINER

| | | | | | |
|----------|--|--------------|-----|----|-----|
| 3BN | Thumbscrew Sink Basket Strainer, Stainless Steel Body and Basket, Triangular Threaded Flange w/ Three Thumbscrews for Easy Installation and Brass Nuts, Neoprene Stopper | 041193108593 | 1.0 | 24 | 17 |
| 4204-3-3 | Replacement Basket for 3BN | 041193022080 | .01 | 1 | .16 |



THREADED BODY STRAINERS

| | | | | | |
|----------|---|--------------|-----|----|-----|
| 6 | "Super 6" Sink Basket Strainer, Stainless Steel Body and Basket, Rubber Stopper w/ Metal Post, Extra Wide Locknut, Extra Thick Washer | 041193054531 | 1.0 | 24 | 19 |
| 6T | Same as Above w/ 4" Chrome Plated Tailpiece | 041193121288 | 1.2 | 24 | 22 |
| 4204-6-3 | Replacement Basket for 6 (new style snap-in metal spring) | 041193003683 | .01 | 1 | .04 |



| | | | | | |
|---|---|---------------|-----|----|---|
| 9 | Economy Sink Basket Strainer, ABS Body w/ Stainless Steel Rim and Basket. Rubber Stopper w/ Plastic Post, ABS Locknut | 2041193102522 | 1.0 | 24 | 9 |
|---|---|---------------|-----|----|---|



| | | | | | |
|----------|--|--------------|-----|----|-----|
| 10 | Standard Sink Basket Strainer, Stainless Steel Body and Basket. Rubber Stopper w/ Metal Post | 041193050410 | 1.0 | 24 | 14 |
| 10T | Same as 10 w/ 4" Chrome Plated Tailpiece | 041193050557 | 1.0 | 24 | 17 |
| 4201-3-3 | Replacement Basket for 10 | 041193093967 | .01 | 1 | .25 |





| Product No. | Description | U.P.C. Code | Cu.Ft. | Ctn. Qty. | Ctn. Wt. |
|-------------------------------------|--|--------------|--------|-----------|----------|
| LOCKING CUP STRAINERS (CONT) | | | | | |
| 11 | Standard Sink Basket Strainer, Stainless Steel Body and Basket. Rubber Stopper w/ Chromed Plastic Post | 041193014344 | 1.0 | 24 | 15 |
| 11T | Same as Above w/ 4" Chrome Plated Tailpiece | 041193055965 | 1.2 | 24 | 17 |
| 4201-4-3 | Replacement Basket for 11 | 041193114754 | .01 | 1 | .17 |



| | | | | | |
|----------|---|--------------|-----|----|-----|
| 16 | Sink Basket Strainer, Brass Body w/ Stainless Steel Basket. Deep Locking Cup. Rubber Stopper. Length-3-3/4" | 041193050816 | 1.0 | 24 | 19 |
| 16BN | Same as 16 w/ Brass Nuts | 041193095411 | 1.0 | 24 | 20 |
| 16T | Same as 16 w/ 4" Chrome Plated Tailpiece | 041193110145 | 1.0 | 24 | 24 |
| 4201-3-3 | Replacement Basket for 16 | 041193093967 | .01 | 1 | .25 |



| | | | | | |
|-----------|---|--------------|-----|----|-----|
| 17 | "Spin-N-Lock" Sink Basket Strainer, Stainless Steel Body w/ Stainless Steel Screw-In Basket | 041193050823 | 1.0 | 24 | 20 |
| 17BN | Same as 17 w/ Brass Nuts | 041193000149 | 1.0 | 24 | 21 |
| 17T | Same as 17 w/ 4" Chrome Plated Tailpiece | 041193110275 | 1.2 | 24 | 24 |
| 4201-17-3 | Replacement Basket for 17 | 041193114730 | .01 | 1 | .25 |



| | | | | | |
|------|--|--------------|-----|----|----|
| 816 | Cast Brass Body Sink Basket Strainer, Stainless Steel Basket w/ Brass Slide Post, Cast Brass Stopper and Brass Locknut. Heavy Duty Commercial Grade. | 041193057648 | 1.0 | 24 | 33 |
| 816T | Same as Above w/ 4" Chrome Plated 17 Ga. Tailpiece | 041193126719 | 1.3 | 24 | 35 |



BAR SINK STRAINERS

| | | | | | |
|----------|--|--------------|-----|----|-----|
| 3784 | Junior Duo Bar Sink Strainer, Stainless Steel Body and Basket. Length 1-1/8" | 041193071194 | .30 | 12 | 4 |
| 3784BN | Same as 3784 w/ Brass Nuts | 041193011732 | .30 | 12 | 4 |
| 3784T | Same as 3784 w/ 4" Chrome Plated Tailpiece | 041193113511 | .51 | 12 | 5 |
| 4201-5-3 | Replacement Basket for 3784 | 041193114761 | .01 | 1 | .03 |



| | | | | | |
|-------|--|--------------|-----|----|----|
| 774 | Duplex Sink Strainer, Brass Body w/ Flat Stainless Steel Strainer for 2-1/2" Opening | 041193055187 | .30 | 12 | 5 |
| 774BN | Same as 774 w/ Brass Nuts | 041193011725 | .30 | 12 | 5 |
| 774T | Same as 774 w/ 4" Chrome Plated Tailpiece | 041193125422 | .51 | 12 | 12 |



| | | | | | |
|------|---|--------------|-----|----|---|
| 774A | Tray Plug Sink Basket Strainer, Brass Body w/ Rubber Stopper for 2-1/2" Opening | 041193049940 | .30 | 12 | 5 |
|------|---|--------------|-----|----|---|

| Product No. | Description | U.P.C. Code | Cu.Ft. | Ctn. Qty. | Ctn. Wt. |
|---------------------------|---|--------------|--------|-----------|----------|
| BAR SINK STRAINERS | | | | | |
| 3785A | Standard Bar Sink Strainer, Brass Body and Crumb Cup. Length - 2-1/8" | 041193071200 | .30 | 12 | 6 |
| 3785ABN | Same as 3785A w/ Brass Nuts | 041193011787 | .30 | 12 | 6 |
| 3785AT | Same as 3785A w/ 4" Chrome Plated Tailpiece | 041193113528 | .51 | 12 | 6 |
| 4201-8-1 | Replacement Basket for 3785A | 041193114778 | .01 | 1 | .05 |



| | | | | | |
|-------|---|--------------|-----|----|---|
| 815B | Flat Top Sink Basket Strainer, Brass Body and Stainless Steel Strainer. Length - 1-7/8" | 041193006134 | .30 | 12 | 5 |
| 815BT | Same as 815B w/ 4" Chrome Plated Tailpiece | 041193126634 | .51 | 12 | 7 |



REPAIR PARTS FOR BASKET STRAINERS

| | | | | | |
|----------|--|--------------|-----|---|-----|
| 4202-2-3 | Rubber Washer For 6, 9, 10, 11, 14, 16, 17, 18, 815B And 816 | 041193114792 | .01 | 1 | .04 |
|----------|--|--------------|-----|---|-----|



DECORATOR BRASS STRAINER ASSEMBLIES

| | | | | | |
|------|---|--------------|-----|---|---|
| 7U | Brass Strainer, w/ Brass Basket and Stopper, UltraShine® Polished Brass | 041193010506 | .30 | 6 | 8 |
| 7CHR | Brass Strainer, w/ Brass Basket and Stopper, Polished Chrome Finish | 041193011695 | .30 | 6 | 8 |



DECORATOR PLASTIC STRAINER ASSEMBLIES

| | | | | | |
|---------|--|--------------|-----|----|----|
| 9BC | Plastic Strainer Assembly, Biscuit Color, Clamshell | 041193084897 | .62 | 6 | 6 |
| 9BC-BX | Plastic Strainer Assembly, Biscuit Color, Boxed | 041193018274 | .70 | 12 | 12 |
| 9WH | Plastic Strainer Assembly, White Color, Clamshell | 041193084859 | .62 | 6 | 6 |
| 9WH-BX | Plastic Strainer Assembly, White Color, Boxed | 041193011718 | .70 | 12 | 12 |
| 9BNE | Plastic Strainer Assembly, Bone Color, Clamshell | 041193084866 | .62 | 6 | 6 |
| 9BNE-BX | Plastic Strainer Assembly, Bone Color, Boxed | 041193011817 | .70 | 12 | 12 |
| 9EWH | Plastic Strainer Assembly, Euro-White Color, Clamshell | 041193084873 | .62 | 6 | 6 |
| 9EWH-BX | Plastic Strainer Assembly, Euro-White Color, Boxed | 041193018281 | .70 | 12 | 12 |
| 9BL | Plastic Strainer Assembly, Black Color, Clamshell | 041193084880 | .62 | 6 | 6 |
| 9BL-BX | Plastic Strainer Assembly, Black Color, Boxed | 041193018298 | .70 | 12 | 12 |



DECORATOR BRASS DISPOSER FLANGES

| | | | | | |
|-------|---|--------------|-----|---|---|
| D7U | Disposer Flange and Stopper, UltraShine® Polished Brass Finish, Boxed | 041193010544 | .30 | 6 | 8 |
| D7CHR | Disposer Flange and Stopper, Brass Polished Chrome Finish, Boxed | 041193010551 | .30 | 6 | 8 |



DECORATOR PLASTIC DISPOSER FLANGES

| | | | | | |
|----------|---|--------------|-----|----|----|
| D9BC | Disposer Flange Assembly, Biscuit Color, Clamshell | 041193084941 | .62 | 6 | 6 |
| D9BC-BX | Disposer Flange Assembly, Biscuit Color, Boxed | 041193018304 | .70 | 12 | 12 |
| D9WH | Disposer Flange Assembly, White Color, Clamshell | 041193084903 | .62 | 6 | 6 |
| D9WH-BX | Disposer Flange Assembly, White Color, Boxed | 041193011640 | .70 | 12 | 12 |
| D9BNE | Disposer Flange Assembly, Bowl, Bone Color, Clamshell | 041193084910 | .62 | 6 | 6 |
| D9BNE-BX | Disposer Flange Assembly, Bowl, Bone Color, Boxed | 041193011664 | .70 | 12 | 12 |
| D9EWH | Disposer Flange Assembly, Euro-White Color, Clamshell | 041193084927 | .62 | 6 | 6 |
| D9EWH-BX | Disposer Flange Assembly, Euro-White Color, Boxed | 041193018311 | .70 | 12 | 12 |
| D9BL | Disposer Flange Assembly, Black Color, Clamshell | 041193084934 | .62 | 6 | 6 |
| D9BL-BX | Disposer Flange Assembly, Black Color, Boxed | 041193018328 | .70 | 12 | 12 |



POLISHED BRASS BAR STRAINER

| | | | | | |
|-------|---|--------------|-----|---|----|
| 23030 | Bar Sink Strainer w/ Crumb Cup. Length 2-1/8", Polished Brass | 041193111463 | .02 | 1 | .7 |
|-------|---|--------------|-----|---|----|



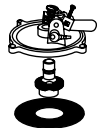

| Product No. | Size | Description | U.P.C. Code | Cu. Ft. | Ctn. Qty. | Ctn. Wt. |
|---------------------------------|--------|--|--------------|---------|-----------|----------|
| PISTON VALVE FILL VALVES | | | | | | |
| 910001 | 8-1/2" | Regular Fill valve, 9" refill tube and holder, printed box, 6-3/16" Critical Length (A1) | 041193128386 | 2.28 | 36 | 21 |
| 910001B | | Same as 910001 except all components packed in an individual bag | 041193128393 | 1.57 | 36 | 22 |
| 910005 | | Same as 910001 except all components packed separately in one carton, bulk | 041193128461 | 4.66 | 125 | 64 |

| | | | | | | |
|---------|--------|--|--------------|------|-----|------|
| 910003 | 8-1/2" | Anti-Siphon fill valve, 9" refill tube and holder, printed box, 6-3/16" Critical Length (A51) | 041193128430 | 2.28 | 36 | 22.0 |
| 910004 | 10" | Anti-Siphon fill valve, 7-1/8" refill tube and holder, printed box, 7-7/8" Critical Length (A52) | 041193128447 | 2.28 | 36 | 23.0 |
| 910004B | | Same as 910003 except all components packed in an individual bag | 041193128454 | 2.28 | 36 | 23.0 |
| 910008 | | Same as 910003 except all components packed separately in one carton, bulk | 041193128485 | 4.66 | 100 | 40.0 |
| 910002 | 12" | Anti-Siphon fill valve, 7-1/8" refill tube and holder, printed box, 9-7/8" Critical Length (A50) | 041193128409 | 2.28 | 36 | 24.0 |

| | | | | | | |
|--------|-----------|---|--------------|------|----|------|
| 910126 | 9" To 13" | Adjustable Anti-Siphon Fill valve, 7-1/8" refill tube and holder, printed box (A62) | 041193128515 | 2.28 | 36 | 24.0 |
|--------|-----------|---|--------------|------|----|------|

BONNETS

| | | | | | | |
|--------|--|--|--------------|------|----|-----|
| 930281 | | Bonnet for Anti-Siphon Fill valve, (fits fill valves made prior to October, 1985). Top refill - 90° refill on leg. Includes top with arm, adjusting screw and diaphragm (11869-2). | 041193026996 | 1.16 | 50 | 5.0 |
|--------|--|--|--------------|------|----|-----|

| | | | | | | |
|--------|--|---|--------------|------|----|-----|
| 930014 | | Bonnet for regular fill valves, includes top with arm, adjusting screw and diaphragm (11869-3). | 041193128713 | 1.16 | 50 | 5.0 |
|--------|--|---|--------------|------|----|-----|

| | | | | | | |
|--------|--|--|--------------|------|----|-----|
| 930015 | | Bonnet for Anti-Siphon fill valves (fits fill valves made since October 1985). No top refill connection. Includes top with arm, adjusting screw and diaphragm (11869-4). | 041193128720 | 1.16 | 50 | 5.0 |
|--------|--|--|--------------|------|----|-----|

FILL VALVE COMPONENTS

| | | | | | | |
|--------|--|--|--------------|-----|-----|-----|
| 930100 | | Wing Coupling Nut - 5/8" Center Hole, plastic (1911-2) | 041193128942 | .07 | 100 | 1.7 |
|--------|--|--|--------------|-----|-----|-----|

| | | | | | | |
|--------|--|-------------------------------|--------------|-----|-----|---|
| 930103 | | 9" Vinyl Refill Tube (190617) | 041193128973 | .07 | 100 | 2 |
|--------|--|-------------------------------|--------------|-----|-----|---|

| | | | | | | |
|--------|--|-----------------------|--------------|-----|-----|-----|
| 930133 | | Tank Lever Nut, Brass | 041193129116 | .07 | 100 | 4.1 |
|--------|--|-----------------------|--------------|-----|-----|-----|

FILL VALVE REPAIR KITS

| | | | | | | |
|--------|--|--|--------------|------|----|-----|
| 930012 | | Repair Kit (Bulk) Piston Assembly, Diaphragm and 4 Screw (11868-4) | 041193128690 | 1.16 | 50 | 5.0 |
|--------|--|--|--------------|------|----|-----|

| | | | | | | |
|--------|--|--|--------------|------|----|-----|
| 930025 | | Repair Kit (Bulk) Piston Assembly, Diaphragm and 1 Screw (11868) | 041193128744 | 1.40 | 50 | 2.4 |
|--------|--|--|--------------|------|----|-----|

| Product No. | Description | U.P.C. Code | Cu.Ft. | Ctn. Qty. | Ctn. Wt. |
|----------------------------------|--|--------------|--------|-----------|----------|
| FLUSH VALVES | | | | | |
| 920127 | 8-11/16" Overflow Level (Printed Box). Vinyl flapper with 8-1/2" chain and hook, 1996 hex nut assembled (3903) | 041193128560 | 2.7 | 24 | 12.0 |
| 920137 | 8-11/16" Overflow Level (Bulk). Vinyl flapper with 8-1/2" chain and hook, 1996 hex nut assembled (3903) | 041193128607 | 1.4 | 25 | 9.5 |
| 920055 | 8-11/16" Overflow Level (BULK). Vinyl flapper with 8-1/2" chain and hook, 1996 hex nut assembled (3903) | 041193000538 | 4.7 | 100 | 30 |
| <hr/> | | | | | |
| 920199 | 8-11/16" Overflow Level. Vinyl flapper with molded strap. 1996 hex nut packaged separately. | 041193128645 | 1.4 | 25 | 9.5 |
| <hr/> | | | | | |
| 920128 | 10-5/8" Overflow Level (Printed Box). Vinyl flapper with 12-1/4" chain and hook, 1996 hex nut assembled (3904) | 041193128577 | 2.7 | 24 | 12.5 |
| 920138 | 10-5/8" Overflow Level (Bulk). Vinyl flapper with 12-1/4" chain and hook, 1996 hex nut assembled (3904) | 041193128614 | 1.4 | 25 | 9.8 |
| <hr/> | | | | | |
| 920200 | 10-11/16" Overflow Level, Vinyl flapper with molded strap | 041193128652 | 1.4 | 25 | 9.5 |
| <hr/> | | | | | |
| VINYL FLAPPERS WITH CHAIN | | | | | |
| 930043 | Three Way Vinyl Flapper (Printed Box). Fits plastic, brass, and old Crane® "57" flush valves. Includes 9" chain and hook (5980B) | 041193128836 | .71 | 24 | 4.3 |
| 930020 | Three Way Vinyl Flapper (Bulk). Fits plastic, brass, and old Crane® "57" flush valves. Includes 9" chain and hook (5980B) | 041193128737 | 4.6 | 200 | 25.2 |
| <hr/> | | | | | |
| 930040 | Vinyl Flapper (Printed Box) fits plastic flush valves, includes 9" chain and hook (4980) | 041193128812 | .71 | 24 | 3.7 |
| 930002 | Vinyl Flapper (White Box) fits plastic flush valves, includes 9" chain and hook (4980) | 041193001863 | .62 | 24 | 3.0 |
| 930003 | Vinyl Flapper (Bulk) fits plastic flush valves, includes 9" chain and hook (4980) | 041193128683 | 4.6 | 200 | 22.0 |
| <hr/> | | | | | |
| 930298 | Clear Vinyl flapper w/ 9" chain and hook (Printed Box) | 041193095015 | .17 | 24 | 5.6 |
| 930067 | Clear Vinyl flapper w/ 9" chain and hook (Bulk) | 041193089403 | 4.6 | 200 | 21.2 |
| <hr/> | | | | | |
| WATER SAVING FLAPPERS | | | | | |
| 930042TR | Timed Rate Flapper Kit (Bagged) Vinyl flapper w/ 9" chain, hook and baffles | 041193081209 | .40 | 24 | 3.0 |





| Product No. | Size | Description | U.P.C. Code | Cu. Ft. | Ctn. Qty. | Ctn. Wt. |
|---|------|---|--------------|---------|-----------|----------|
| VINYL FLAPPERS WITH MOLDED STRAP | | | | | | |
| 930048 | | Three Way Vinyl Flapper (Bulk). Fits plastic, brass, and old Crane® "57" flush valves | 041193128867 | 4.6 | 200 | 22.0 |
| 930051 | | Vinyl Flapper (Printed Box). Fits plastic flush valves | 041193128874 | .28 | 24 | 4.0 |
| 930055 | | Vinyl Flapper (Bulk). Fits plastic flush valves | 041193128881 | 4.6 | 200 | 2.2 |
| 930068 | | Clear Vinyl Flapper w/ Strap, Bulk | 041193027009 | 4.6 | 200 | 22.0 |
| RUBBER FLAPPERS | | | | | | |
| 930039 | | Round Rubber Flapper (Printed Box). Fits plastic flush valves, original equipment on Kohler®. Includes 8" chain and hook (4979) | 041193128805 | .25 | 24 | 4.3 |
| 930001 | | Round Rubber Flapper (White Box). Fits plastic flush valves, original equipment on Kohler®. Includes 8" chain and hook (4979) | 041193128669 | .63 | 24 | 5.0 |
| 930037 | | Round Rubber Flapper (Bulk). Fits plastic flush valves, original equipment on Kohler®. Includes 8" chain and hook (4979) | 041193128782 | 1.4 | 100 | 16.0 |
| FLUSH VALVE COMPONENTS | | | | | | |
| 930117 | | 2" Extra Thick Beveled Washer (Bulk) (19004) | 041193129048 | 1.4 | 100 | 25.0 |
| BRASS FLOAT RODS | | | | | | |
| 938080 | | 8" Solid Brass Rod (Bulk) | 041193129161 | .02 | 100 | 5.0 |
| TANK BALL FLOATS | | | | | | |
| 930118 | | Plastic Tank Float (Bulk). High Buoyancy, Black Polypropylene (P83) | 041193129055 | 4.1 | 100 | 13.3 |
| SPUD WASHERS | | | | | | |
| 4025 | -NEW | 2" x 2" Closet Spud | 041193052971 | .09 | 6 | 4.63 |
| 4026 | -NEW | 2" x 1-1/2" Closet Spud | 041193113894 | .09 | 6 | 3.9 |
| 4028 | -NEW | 1-1/2" x 1-1/2" Closet Spud | 041193052988 | .46 | 6 | 3.241 |
| 4028A | -NEW | 1-1/2" x 1-1/4" Closet Spud | 041193113900 | .06 | 6 | 3.09 |
| 4029 | -NEW | 1-1/4" x 1-1/4" Closet Spud | 041193113917 | .02 | 6 | 2.4 |
| 4030 | -NEW | 1" x 3/4" Urinal Spud | 041193113955 | .04 | 6 | 1.85 |
| 4031 | -NEW | 1-1/4" x 3/4" Urinal Spud | 041193113962 | .04 | 6 | 2.33 |
| 4032 | -NEW | 1-1/2" x 3/4" Urinal Spud | 041193113979 | .06 | 6 | 2.38 |
| 7101 | -NEW | 1-1/2" Flanged Spud Washer | 041193054708 | .36 | 25 | 1.15 |
| 7102 | -NEW | 2" Flanged Spud Washer | 041193054715 | .04 | 25 | 1.68 |
| 7105 | -NEW | 1" x 3/4" Flanged Spud Washer | 041193123985 | .05 | 25 | .95 |
| BOLT CAPS | | | | | | |
| 930125 | | Round Plastic Bolt Cap (Bulk), White, Snap-On (1912) | 041193129079 | 1.4 | 100 | 14.0 |

| Product No. | Description | U.P.C. Code | Cu.Ft. | Ctn. Qty. | Ctn. Wt. |
|-----------------------------|--|--------------|--------|-----------|----------|
| CLOSET BOLTS /SCREWS | | | | | |
| 8545C | -NEW Tank to Bowl Bolt Kit w/ Galvanized Spud Washer | 041193030207 | .3 | 50 | 11.75 |
| 8546 | -NEW Tank to Bowl Bolt Kit w/ Brass Spud Washer | 041193059907 | .3 | 50 | 9.55 |
| 8512C | Toilet Screw Set, 5/16" x 2-1/2" Brass Closet Screws 2 Brass Screws w/ Nuts and Washers | 041193094490 | .02 | 50 | 9.3 |
| 8525C | Toilet Bolts, 1/4" x 2-1/2" Plated, Oregon Pattern | 041193030115 | .74 | 50 | 14.0 |



FLUSH LEVERS

| | | | | | |
|--------|---|--------------|------|-----|------|
| 702007 | Chrome, Plastic Spud And Nut, Round Brass Arm - 8" | 041193123060 | 2.9 | 100 | 28.0 |
| 702033 | Chrome, Plastic Spud And Nut, Round Brass Arm - 8" | 041193123145 | 1.2 | 24 | 18.0 |
| 702034 | Chrome, Zinc spud and Nut, Round Brass Arm - 8" | 041193003928 | 1.2 | 24 | 10.0 |
| 703009 | Chrome, Zinc Spud And Nut, Round Brass Arm - 8" | 041193123275 | 1.2 | 24 | 12.0 |
| 4225B | -NEW Economy Flush Lever, Chrome Plated Plastic w/ Plastic Spud | 041193033017 | .425 | 25 | 5 |
| 4223 | -NEW Alloy Rod Flush Lever, Chrome Plated w/Die Cast Spud | 041193114846 | .75 | 25 | 4.5 |

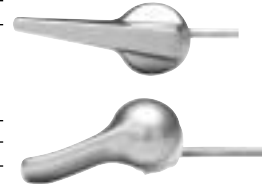

TOILET ACCESSORIES

| | | | | | |
|------|---|--------------|------|----|-----|
| 4211 | -NEW Toilet Tank Cover | 041193053213 | .236 | 1 | 2 |
| 7520 | -NEW Three Way Rubber Flapper | 041193124685 | .525 | 25 | 3.1 |
| 7555 | -NEW 6-3/4" Form Fit Closet Bowl Sponge Rubber Gasket | 041193055101 | .44 | 10 | 4.7 |
| 7556 | -NEW 5-3/4" O.D. x 3-1/2" Closet Bowl Sponge Rubber Gasket | 041193124739 | .71 | 10 | 2.3 |
| 7557 | -NEW 3-1/4" O.D x 2-1/8" Tank to Bowl Sponge Rubber Gasket for Close Couple Connection | 041193055118 | .31 | 24 | 1.9 |



WRENCHES, TOOLS & PLUNGERS

| | | | | | |
|--------|--|--------------|------|----|------|
| 3003 | -NEW Strainer Locknut Wrench w/Hinged Jaw | 041193052315 | .3 | 6 | 4.4 |
| 3010 | -NEW Large Jaw Basin Wrench w/ 15" Handle | 041193052353 | .05 | 1 | 1.9 |
| 3030 | -NEW 1" - 4" Spud Wrench for Removal or Installation of Closet Spuds, Sink Strainers, P.O Plugs, Waste & Overflow | 041193052407 | .27 | 10 | 12.6 |
| 3032 | -NEW Tub Waste Wrench - Fits 1-1/2" and 1-1/4" Sizes | 041193071484 | .01 | 1 | .47 |
| 3040G | -NEW 2" Heavy Duty Pliers with Vinyl Grips | 041193112026 | .001 | 1 | 1.1 |
| 3068 | -NEW Socket Wrench Set with 5 Socket Wrenches | 041193052421 | .07 | 1 | 1.9 |
| 3070 | -NEW Strainer Wrench | 041193052438 | .08 | 6 | 3.3 |
| 3080B | -NEW No-Hub Torque Wrench w/ 5/16" Hex Socket and Reversing Lever | 041193071569 | .01 | 1 | .43 |
| 3713 | -NEW Swedge Tool for 3/8", 1/2" & 3/4" I.D. Nominal sizes to 5/8" & 7/8" O.D. Tubing | 041193071859 | .01 | 1 | .74 |
| 5126 | -NEW 1/8" NPT Bright Plated Loose Key Coin Air Vent | 041193049056 | .03 | 25 | .8 |
| 5130 | -NEW 1/4" NPT Bright Finish Vent Key | 041193049063 | .22 | 20 | .26 |
| 5236 | -NEW 1/4" NPT Straight Type Steel Siphon | 041193119247 | .17 | 12 | 3.9 |
| 7981FW | -NEW Four Way Key | 041193125965 | .05 | 12 | 4.4 |
| 7502 | -NEW 6" Diameter Plunger w/ 18" Handle | 041193024848 | .53 | 12 | 8.8 |
| 7505 | -NEW Samson Force Cup Plunger w/ 18" Handle | 041193024879 | .47 | 5 | 6.4 |

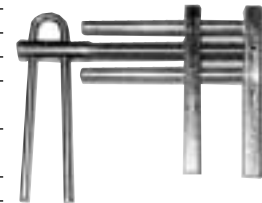

PIPE REPAIR CLAMPS

| | | | | | |
|-------|---|---------------|-----|----|-----|
| 8201 | -NEW 1/2" NPT Cadmium Plated Steel Pipe Repair Clamp w/Neoprene Gasket | 041193048193 | .13 | 6 | 2.8 |
| 8202 | -NEW 3/4" NPT Cadmium Plated Steel Pipe Repair Clamp w/Neoprene Gasket | 041193049216 | .13 | 6 | 3.4 |
| 8203 | -NEW 1" NPT Cadmium Plated Steel Pipe Repair Clamp w/Neoprene Gasket | 041193049209 | .13 | 10 | 8.5 |
| 8204 | -NEW 1-1/4" NPT Cadmium Plated Steel Pipe Repair Clamp w/Neoprene Gasket | 041193049223 | .30 | 6 | 6 |
| 8205B | -NEW 1-1/2" NPT Cadmium Plated Steel Pipe Repair Clamp w/Neoprene Gasket | 041193049230 | .05 | 1 | 1 |
| 8206 | -NEW 2" NPT Cadmium Plated Steel Pipe Repair Clamp w/Neoprene Gasket | 041193049247 | .05 | 1 | 1.2 |
| 6200C | -NEW 1/8" x 24" Graphite Twist Packing w/individual strand - Bagged | 0411930203056 | .14 | 48 | 1.1 |





| Product No. | Size | Description | U.P.C. Code | Cu. Ft. | Ctn. Qty. | Ctn. Wt. |
|---|-----------------|----------------------------|--------------|---------|-----------|----------|
| GROUND JOINT PART WASTE CONNECTORS | | | | | | |
| 1004 | 1-1/4" x 1-1/4" | Male (Female Copper Sweat) | 041193050434 | .03 | 6 | 2.1 |
| 1005 | 1-1/2" x 1-1/2" | Male (Female Copper Sweat) | 041193050441 | .03 | 6 | 2.4 |
| R1006 | 1-1/4" x 1-1/2" | Male (Female Copper Sweat) | 041193105493 | .03 | 6 | 2.3 |

| | | | | | | |
|-------|--------|------------|--------------|-----|----|----|
| B1005 | 1-1/2" | Brass Ring | 041193055903 | .28 | 10 | .4 |
| B1004 | 1-1/4" | Brass Ring | 041193055897 | .13 | 10 | .5 |

| | | | | | | |
|---------|-----------------|--|--------------|-----|---|-----|
| 1012 | 1-1/4" x 1-1/4" | Female, Ground Joint Waste Connector | 041193106339 | .03 | 6 | 2.2 |
| 1013 | 1-1/2" x 1-1/2" | Female, Ground Joint Waste Connector | 041193050458 | .03 | 6 | 2.6 |
| HD1013C | 1-1/2" x 1-1/2" | Female, Ground Joint Waste Connector, Ind. Bag, Display Box | 041193015785 | .13 | 6 | 3.0 |

| | | | | | | |
|---------|-----------------|--|--------------|-----|---|-----|
| 1014 | 1-1/4" x 1-1/2" | Female, Ground Joint Waste Connector | 041193050465 | .03 | 6 | 2.5 |
| HD1014C | 1-1/4" x 1-1/2" | Female, Ground Joint Waste Connector, Ind. Bag, Display Box | 041193015792 | .05 | 6 | 3.0 |

BULK SLIP NUTS - BRASS

| | | | | | | |
|-------|-----------------|-----------------------------------|--------------|-----|----|-----|
| 8006 | 1-1/2" x 1-1/2" | Slip Nut w/ Washer, Chrome Plated | 041193126146 | .09 | 50 | 5.5 |
| 8006R | 1-1/2" x 1-1/2" | Brass Nut, Unfinished | 041193015938 | .09 | 50 | 5.0 |
| 8007 | 1-1/4" x 1-1/4" | Slip Nut w/ Washer, Chrome Plated | 041193126153 | .09 | 50 | 5.0 |
| 8008 | 1-1/2" x 1-1/4" | Slip Nut w/ Washer, Chrome Plated | 041193126160 | .09 | 50 | 5.0 |
| 8009 | 1-1/2" x 1-3/8" | Slip Nut w/ Washer, Chrome Plated | 041193126177 | .09 | 50 | 5.0 |
| 8011 | 2" x 2" | Slip Nut w/ Washer, Chrome Plated | 041193126238 | .09 | 25 | 5.0 |

BULK SLIP NUTS - DIE CAST

| | | | | | | |
|--------|-----------------|---|--------------|-----|-----|-----|
| 8030 | 1-1/4" x 1-1/4" | Die Cast Nut, Chrome Plated | 041193006332 | .09 | 50 | 2.7 |
| 8030LW | 1-1/4" x 1-1/4" | Die Cast Nut, Chrome Plated, Less Washer | 041193055453 | .17 | 100 | 4.6 |
| 8031 | 1-1/2" x 1-1/4" | Die Cast Nut, Chrome Plated | 041193050083 | .09 | 50 | 4.0 |
| 8031LW | 1-1/2" x 1-1/4" | Die Cast Nut, Chrome Plated, Less Washer | 041193055460 | .17 | 100 | 6.4 |
| 8032 | 1-1/2" x 1-3/8" | Die Cast Nut, Chrome Plated | 041193055477 | .09 | 50 | 3.5 |
| 8033 | 1-1/2" x 1-1/2" | Die Cast Nut, Chrome Plated | 041193006349 | .09 | 50 | 3.5 |
| 8033LW | 1-1/2" x 1-1/2" | Die Cast Nut, Chrome Plated, Less Washer | 041193055491 | .17 | 100 | 5.7 |
| 8034 | 2" x 2" | Die Cast Nut, Chrome Plated | 041193049384 | .09 | 25 | 2.4 |
| 8035 | 2" x 1-1/2" | Die Cast Nut, Chrome Plated | 041193126351 | .09 | 25 | 1.9 |

NUTS & WASHERS IND. BAG

| | | | | | |
|---------|--|--------------|-----|----|-----|
| HD8030C | Zinc Nut & Washer Slip Joint 1-1/4", Ind. Printed Bag, Display Box | 041193028907 | .31 | 25 | 2.1 |
| HD8033C | Zinc Nut & Washer Slip Joint 1-1/2", Ind. Printed Bag, Display Box | 041193029058 | .56 | 50 | 4.5 |
| HD8031C | Zinc Nut & Washer Slip Joint 1-1/4" x 1-1/2", Ind. Printed Bag, Display Box | 041193028952 | .31 | 25 | 2.7 |

| Product No. | Description | U.P.C. Code | Cu.Ft. | Ctn. Qty. | Ctn. Wt. |
|---------------------|--|--------------|--------|-----------|----------|
| BULK WASHERS | | | | | |
| 7195 | 1-1/2" flanged washer, 1-5/16" I.D. x 1-23/32" O.D. | 041193054814 | .71 | 100 | 3.6 |
| 7196 | 1-1/4" beveled S.J. washer, 1-1/4" I.D. x 1-29/64" O.D. x 7/64" thick. | 041193054821 | .71 | 100 | 3.6 |
| 7198 | 1-1/2" x 1-1/4" beveled washer, bulk | 041193054845 | .71 | 100 | 1.0 |
| 9002 | Plastic Washers | 041193128157 | .71 | 100 | 1.0 |



| | | | | | |
|------|---|--------------|-----|-----|-----|
| 7202 | 1-1/4" Regular, rubber, 1-1/4" I.D. x 1-7/16" O.D., 5/32" thick | 041193054852 | .05 | 100 | 0.6 |
| 7203 | 1-1/2" Regular, rubber, 1-1/2" I.D. x 1-3/4" O.D., 3/16" thick | 041193054869 | .05 | 100 | 0.6 |
| 7204 | 2" Regular, rubber, 1-15/16" I.D. x 2-1/8" O.D., 3/16" thick | 041193049506 | .10 | 100 | 1.0 |
| 7210 | 1-1/2" x 1-1/4", rubber, 1-1/4" I.D. x 1-3/4" O.D., 5/32" thick | 041193054890 | .10 | 100 | 1.2 |

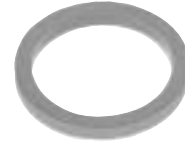

IND. BAGGED WASHERS

| | | | | | |
|---------|---|--------------|-----|----|----|
| HD7202C | Rubber Slip Joint Washer 1-1/4", 3/Card, Ind. Printed Bag, Display Box | 041193024633 | .31 | 25 | .8 |
| HD7203C | Rubber Slip Joint Washer 1-1/2", 3/Card, Ind. Printed Bag, Display Box | 041193024640 | .20 | 50 | .6 |
| HD7210 | Rubber Slip Joint Reducing Washers 1-1/2" x 1-1/4", Ind. Printed Bag, Display Box | 041193054890 | .31 | 25 | .4 |

FLANGES

Low Pattern Chrome Plated

| | | | | | |
|---------|-------------------------------------|--------------|-----|-----|-----|
| 1097 | 3/8" O.D. for 1/4" Nom | 041193107008 | .05 | 50 | 1.0 |
| 1098 | 1/2" O.D. for 3/8" Nom | 041193107015 | .02 | 50 | 1.0 |
| 1099 | 5/8" O.D. for 1/2" Nom | 041193102058 | .15 | 50 | 1.2 |
| 1099A | 7/8" O.D. For 3/4" Nom | 041193102065 | .03 | 50 | 1.1 |
| H1099A | Flat Escutcheon 7/8" Copper, Bagged | 041193025838 | .07 | 25 | 1.0 |
| 1099AB | 7/8" O.D. For 3/4" Nom | 041193107046 | .15 | 250 | 5.8 |
| 1099B | 5/8" O.D. For 1/2" Nom | 041193107053 | .14 | 250 | 5.8 |
| 1100 | 3/8" NPT | 041193032294 | .05 | 50 | 1.2 |
| HD1831C | Flange 3/8" IPS, Bagged | 041193012555 | .28 | 25 | 1.9 |
| 1100B | 3/8" NPT | 041193107312 | .15 | 250 | 6.0 |
| 1101 | 1/2" NPT | 041193102072 | .03 | 50 | 1.1 |
| HD75C | Flange 1/2" IPS, Bagged | 041193005656 | .28 | 25 | 1.9 |
| 1101A | 3/4" NPT | 041193102089 | .03 | 50 | 1.7 |
| HD76C | Flange 3/4" IPS, Bagged | 041193005700 | .28 | 25 | 1.9 |
| 1101AA | 1" NPT | 041193107343 | .05 | 50 | 1.6 |
| 1101B | 1/2" NPT | 041193107350 | .15 | 250 | 5.5 |
| 1102 | 1-1/4" O.D. | 041193107367 | .08 | 50 | 1.5 |
| HD72C | Flange Tube 1-1/4", Bagged | 041193005557 | .28 | 25 | 1.8 |
| 1104 | 1-1/2" O.D. | 041193107374 | .05 | 50 | 1.3 |
| HD73C | Flange Tube 1-1/2", Bagged | 041193005601 | .28 | 25 | 1.6 |
| 1104A | 2" O.D. | 041193107381 | .11 | 50 | 2.1 |
| 1105 | 1-1/4" NPT | 041193102096 | .07 | 50 | 2.0 |
| 1106 | 1-1/2" NPT | 041193107404 | .05 | 50 | 1.5 |
| 1106A | 2" NPT | 041193107411 | .11 | 50 | 2.3 |
| 1106B | 1-1/2" NPT | 041193107428 | .26 | 250 | 6.5 |



High Pattern Chrome Plated

| | | | | | |
|-------|---------------------------------|--------------|-----|----|------|
| 1107A | 3/8" O.D. For 1/4" Nom | 041193107435 | .07 | 50 | 2.0 |
| 1107B | 1/2" O.D. For 3/8" Nom | 041193107442 | .05 | 50 | 1.9 |
| 1107C | 5/8" O.D. For 1/2" Nom | 041193107459 | .03 | 50 | 10.0 |
| 1107D | 11/16" O.D. For Sweat Extension | 041193107466 | 1.5 | 50 | 2.0 |
| 1109 | 3/8" I.P.S. | 041193107473 | .03 | 50 | 1.9 |
| 1110 | 1/2" NPT | 041193050021 | .03 | 50 | 1.9 |
| 1114 | 1-1/4" O.D. | 041193107510 | .05 | 50 | 3.2 |
| 1114A | 1-1/4" NPT | 041193107527 | .02 | 50 | 3.6 |
| 1115 | 1-1/2" O.D. | 041193107534 | .05 | 50 | 3.2 |
| 1115A | 1-1/2" NPT | 041193107541 | .02 | 50 | 3.7 |





| Product No. | Size | Description | U.P.C. Code | Cu. Ft. | Ctn. Qty. | Ctn. Wt. |
|----------------------------------|---|-------------|--------------|---------|-----------|----------|
| Box Pattern Chrome Plated | | | | | | |
| 1116 | 1-1/4" O.D. | | 041193107558 | .10 | 12 | 1.5 |
| H1116 | Flange Box Pattern 1-1/4" O.D., In Bag, Display Box | | 041193107558 | .03 | 25 | 3.0 |
| 1116A | 1-1/4" NPT | | 041193107565 | .15 | 12 | 1.7 |
| 1117 | 1-1/2" O.D. | | 041193107572 | .08 | 12 | 1.6 |
| H1117 | Flange Box Pattern 1-1/4" O.D., In Bag, Display Box | | 041193107572 | .22 | 25 | 3.0 |
| 1117A | 1-1/2" NPT | | 041193107589 | .15 | 12 | 1.6 |
| 1118 | 2" Deep Flange | | 041193015921 | .58 | 12 | 3.5 |

FLOOR AND CEILING PLATES

Copper Tube Sizes - H=Heavy Grade

| | | | | | | |
|---------|---|--|--------------|-----|----|-----|
| 5340 | 1/2" Tube | | 041193054425 | .55 | 12 | 0.5 |
| HD5340C | Floor & Ceiling Plate 1/2" Tube, Bagged | | 041193054432 | .19 | 24 | 2.1 |
| 5340H | 5/8" O.D. .5 Nom | | 041193102331 | .02 | 12 | .8 |
| 5341 | 3/4" Tube | | 041193119957 | .56 | 12 | .4 |
| HD5341C | Floor & Ceiling Plate 3/4" Tube, Bagged | | 041193054449 | .30 | 24 | 2.1 |
| 5341H | 7/8" O.D. 3/4" Nom | | 041193119964 | .03 | 12 | 1.0 |
| 5342 | 1-1/8" O.D. | | 041193119988 | .56 | 12 | .5 |
| 5342H | 1-1/8" O.D. 3/4" | | 041193102348 | .05 | 12 | .8 |
| 5343 | 1-3/8" O.D. | | 041193120021 | .04 | 12 | .5 |
| 5343H | 1-3/8" O.D. 1-1/4" | | 041193102355 | .05 | 12 | 1.2 |
| 5344 | 1 1/2" Nom | | 041193120045 | .03 | 12 | .8 |
| 5344H | 1-5/8" O.D. 1.5 | | 041193102362 | .04 | 12 | 1.3 |
| 5345H | 2-1/8" O.D. 2 Nom | | 041193120069 | .04 | 12 | 1.9 |
| 5346H | 2-5/8" O.D. 2.5 | | 041193120106 | .07 | 12 | 2.4 |
| 5347H | 3-1/8" O.D. 3 Nom | | 041193120137 | .11 | 12 | 2.4 |

Iron Pipe Sizes - H=Heavy Grade

| | | | | | | |
|---------|--|--|--------------|-----|----|-----|
| 5350 | 3/8" IPS | | 041193054456 | .56 | 12 | .5 |
| 5350H | 3/8" IPS | | 041193120144 | .56 | 12 | 1.2 |
| 5351 | 1/2" IPS | | 041193054463 | .56 | 12 | .5 |
| HD5351C | Floor & Ceiling Plate 1/2" IPS, Bagged | | 041193041319 | .06 | 24 | 2.1 |
| 5351H | 1/2" IPS | | 041193120175 | .03 | 12 | 1.0 |
| 5352 | 3/4" IPS | | 041193054470 | .56 | 12 | .6 |
| HD5352C | Floor & Ceiling Plate 3/4" IPS, Bagged | | 041193041326 | .28 | 24 | 2.1 |
| 5352H | 3/4" IPS | | 041193120199 | .03 | 12 | 1.0 |
| 5353 | 1" IPS | | 041193054487 | .56 | 12 | .8 |
| HD5353C | Floor & Ceiling Plate 1" IPS, Bagged | | 041193025821 | .28 | 24 | .7 |
| 5353H | 1" IPS | | 041193120212 | .04 | 12 | 1.1 |
| 5354 | 1-1/4" IPS | | 041193054494 | .86 | 12 | .7 |
| HD5354C | Floor & Ceiling Plate 1-1/4" IPS, Bagged | | 041193038975 | .28 | 12 | 1.2 |
| 5354H | 1-1/4" IPS | | 041193120236 | .04 | 12 | 1.3 |
| 5355 | 1-1/2" IPS | | 041193054500 | .86 | 12 | .6 |
| HD5355C | Floor & Ceiling Plate 1-1/2" IPS, Bagged | | 041193038982 | .42 | 12 | 1.1 |
| 5355H | 1.5" IPS | | 041193120250 | .04 | 12 | 1.4 |
| 5356 | 2" IPS | | 041193102379 | .04 | 12 | 1.0 |
| HD5356C | Floor & Ceiling Plate 2" IPS, Bagged | | 041193025845 | .20 | 12 | 1.1 |
| 5356H | 2" IPS | | 041193120274 | .06 | 12 | 2.2 |
| 5357H | 2.5" IPS | | 041193120298 | .11 | 12 | 2.4 |
| 5358H | 3" IPS | | 041193120304 | .10 | 12 | 2.2 |
| 5359H | 3.5" IPS | | 041193120311 | .40 | 12 | 3.6 |
| 5360H | 4" IPS | | 041193120328 | .60 | 12 | 6.5 |

PLASTIC SPLIT FLANGE

Copper Tube Sizes

| | | | | | | |
|-------|----------|--|--------------|-----|----|-----|
| 5340P | 1/2" Nom | | 041193119940 | .56 | 12 | 1.0 |
| 5341P | 3/4" Nom | | 041193119971 | .56 | 12 | 1.0 |
| 5342P | 1" Nom | | 041193119995 | .56 | 12 | 1.0 |

Iron Pipe Sizes

| | | | | | | |
|-------|------------|--|--------------|-----|----|-----|
| 5351P | 1/2" IPS | | 041193120182 | .56 | 12 | 1.0 |
| 5352P | 3/4" IPS | | 041193120205 | .56 | 12 | 1.0 |
| 5353P | 1" IPS | | 041193120229 | .56 | 12 | 1.0 |
| 5354P | 1-1/4" IPS | | 041193120243 | .56 | 12 | 1.0 |
| 5355P | 1-1/2" IPS | | 041193120267 | .56 | 12 | 1.0 |
| 5356P | 2" IPS | | 041193120281 | .56 | 12 | 1.0 |

| Product No. | Description | U.P.C. Code | Cu.Ft. | Ctn. Qty. | Ctn. Wt. |
|----------------------|--|--------------|--------|-----------|----------|
| SHOWER DRAINS | | | | | |
| 1268 | Shower Drain, Brass Body w/ 3-1/2" Grid, 2", Type M to Caulk | 041193109644 | .07 | 10 | 8.5 |



| | | | | | |
|------------------|------------------------------|--------------|-----|----|-----|
| STRAINERS | | | | | |
| 1256 | Strainer w/ 3 Prongs, 1-7/8" | 041193050670 | .01 | 25 | .83 |
| 1257 | Strainer w/ 3 Prongs, 1-5/8" | 041193050687 | .01 | 25 | .23 |

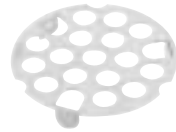

| | | | | | |
|--------------------|---|--------------|-----|----|-----|
| ACCESSORIES | | | | | |
| 5220C | -NEW Self Tapping Saddle Valve | 041193022554 | .17 | 12 | 2.8 |
| 6200C | -NEW 1/8" x 24" Graphite Twist Packing for Faucets, Valves & Pumps | 041193023056 | .14 | 48 | 1.1 |
| 7633C | -NEW 6' High Pressure Washing Machine Hose | 041193026200 | .8 | 6 | 5.4 |



SPECIALTY SINK REPAIR

| | | | | | |
|-------------------------|--|--------------|-----|----|-----|
| DRUM TRAP COVERS | | | | | |
| 1023 | -NEW 3-1/4" - 4" Adj. Drum Trap Cover (Style A) w/ 5-1/4" Stainless Steel Cover & Rubber Gasket | 041193057860 | .22 | 10 | 4 |
| 1024 | -NEW 3-1/4" - 4" Adj. Drum Trap Cover (Style B) w/ 5-1/4" Stainless Steel Cover & Rubber Gasket | 041193057877 | .3 | 10 | 7.9 |

| | | | | | |
|-------------------------|---|--------------|------|----|-----|
| SINK HOLE COVERS | | | | | |
| 1226 | -NEW 2" Sink Hole Cover w/ 2-Piece Stainless Steel Head | 041193050663 | .132 | 12 | 1.5 |
| 1227 | -NEW 1-3/4" Sink Hole Cover w/ 2-Piece Stainless Steel Head | 041193109385 | .12 | 24 | 1.7 |
| 1228 | -NEW 1-3/4" Sink Hole Cover w/ 1-Piece Stainless Steel Head | 041193109392 | .17 | 24 | 2 |
| 1228E | -NEW 1-3/4" Sink Hole Cover w/1-Piece Chrome Plated Steel Head | 041193109408 | .05 | 24 | 1.4 |



| | | | | | |
|--------------------|--|--------------|-----|----|-----|
| ACCESSORIES | | | | | |
| 7983 | -NEW Dishwasher Disposal Hose Connector | 041193125972 | .35 | 50 | 8.8 |
| 8636 | -NEW 1/2" NPT x 1/4" NPT Basin Cock Coupling Nut | 041193049131 | .03 | 25 | 1 |
| 202C | -NEW Replacement Spray Head | 041193007704 | .26 | 12 | 1 |
| 2403E | -NEW 27" Stainless Steel Fit-All Hexagon Lug Lavagtory Legs w/Escutcheons for China Fixtures (one pair) | 041193049865 | .17 | 1 | .6 |
| 7536C | -NEW 1" - 1-3/8" Fit-All White Sink Stopper w/Metal Ring | 041193025708 | .17 | 24 | 1.2 |



SPECIALTY BATHTUB REPAIR

| | | | | | |
|-----------------------|---|--------------|-----|---|-----|
| ADD-ON SHOWERS | | | | | |
| 59 | -NEW 26" x 45" Chrome Plated Brass Add- On Shower Frame w/Wall & Ceiling Supports. 3/4" Diameter | 041193056368 | .65 | 1 | 3.5 |
| R100 | -NEW 26" x 45" Chrome Plated Brass Add- On Shower Frame w/Wall & Ceiling Supports for Fixture w/Bath Faucet in Tub Includes No. 355 Tub Spout, No. 126VWS Shower Head w/ 3/4" NPT, 3-3/8" Centers. 3/4" Diameter | 041193050427 | 1.3 | 1 | 8.1 |
| 104 | -NEW Add-On Shower w/ No. 353 Tub Spout, 3/4" NPT w/ 3/4" x 1/2" Face Bushing | 041193102041 | .44 | 1 | 4.5 |
| 107 | -NEW 1/2" x 21" Bent Riser Add-On Basement Shower w/Soap Dish | 041193106766 | .22 | 1 | 4.2 |



| | | | | | |
|--------------------------------------|--|--------------|-----|---|-----|
| SHOWER HEADS & TUB SPOUTS | | | | | |
| 122WS | -NEW Chrome Plated Brass Water Saving Shower Head | 041193109248 | .01 | 1 | .61 |
| 126CWS | -NEW Chrome Plated Plastic Water Saving Shower Head w/ Plastic Ball Joint | 041193006516 | .03 | 6 | .19 |
| 350 | -NEW Chrome Plated Brass Self-Closing Shower Valve w/Pull Chain | 041193112965 | .02 | 1 | 1.2 |





| Product No. | Size | Description | U.P.C. Code | Cu. Ft. | Ctn. Qty. | Ctn. Wt. |
|-----------------------------------|------|--|--------------|---------|-----------|----------|
| SHOWER HEAD AND TUB SPOUTS | | | | | | |
| 351C | -NEW | Chrome Plated Die Cast Diverter Spout w/ Personal Shower Fitting w/ 3/4" x 1/2" Face Bushing | 041193009050 | .45 | 12 | 7.32 |
| 355 | -NEW | Tub Faucet for No. R100, Add-On Shower Frames | 041193056313 | .08 | 1 | 1.92 |
| 359A | -NEW | Chrome Plated Brass Diverter Spout, 3/4" NPT Wall Connection w/ 3/4" x 1/2" Brass Face Bushing | 041193052667 | .35 | 12 | 15.6 |

SHOWER RODS

| | | | | | | |
|------|------|--|--------------|-----|-----|------|
| 43LF | -NEW | 5' Aluminum Shower Rod, Less Flanges | 041193114976 | .50 | 50 | 24.5 |
| 45C | -NEW | 5' Aluminum Shower Rod, w/ Flanges | 041193044051 | .32 | 6 | 4.02 |
| 80 | -NEW | Shower Rod Flange w/Screws (bagged 1 pair) | 041193055439 | .14 | 24 | 2 |
| 83 | -NEW | Adjustable Plastic Shower Rod Holder | 041193127068 | .35 | 50 | 4.9 |
| 1056 | -NEW | 1-3/8" Plated Steel Shower Curtain Pins | 041193050533 | .1 | 100 | 1.2 |

ACCESSORIES

| | | | | | | |
|-------|------|--|--------------|-----|----|------|
| 89CF | -NEW | 6" Shower Arm w/ Die Cast Flange | 041193128065 | .18 | 20 | 7 |
| 89F | -NEW | 6" Shower Arm w/Flange | 041193033673 | .09 | 10 | .94 |
| 2565 | -NEW | 1/2" x 2-1/2" Offset Bath Supply w/Nuts, Washers & Floor Flange (pair) | 041193052285 | .15 | 1 | 1.41 |
| 2566 | -NEW | 9/16" x 2-1/2" Offset Bath Supply w/Nuts Washers & Floor Flange (pair) | 041193112002 | .15 | 1 | 1.64 |
| 7537C | -NEW | 1-1/2" -2" White Tub Stopper w/ Metal Ring | 041193025807 | .17 | 24 | 1.78 |

